

**XTR**  
**SAFETY**

**NEXGEN**  
**Construction**

Façade Access | External Cladding Systems | Fall Protection



[www.nexgenconstruction.co.uk](http://www.nexgenconstruction.co.uk)  
[info@nexgenconstruction.co.uk](mailto:info@nexgenconstruction.co.uk)

HR-CRV-01-90-B  
90 Degree Curve Anchor - Convex

 Includes

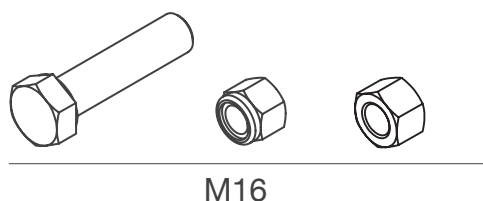
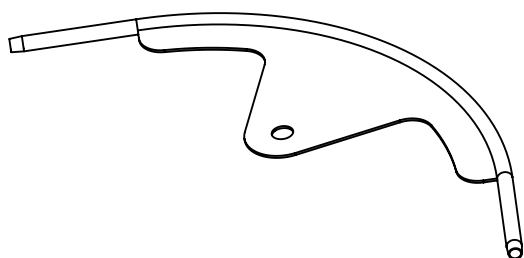

 Installation Tools



2 x 24 Spanner

 Final Product

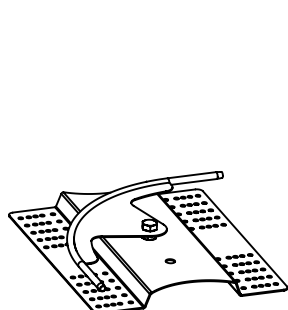

 ANC-PNL-01

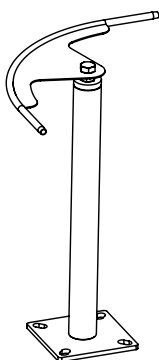

 ANC-POS-01

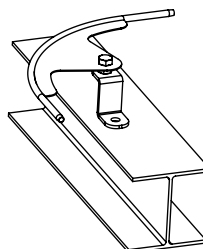

 BRK-04

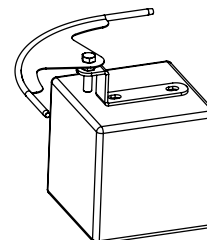

 BRK-05

 0,65 kg

Min. Strength

30 kN

Material

AISI 304